



Model	SWL	Boat Length	Sail Area	Weight
010S	900kg/1980lb	6-10.5m/20-34ft	40m ² /420sq ft	
012M	2400kg/5280lb	10.5-12m/34-40ft	100m ² /1070sq ft	793g/1lb 12oz
012R	2400kg/5280lb	10.5-12m /34-40ft	100m ² /1070sq ft	679g/1lb 8oz
012TD	2400kg/5280lb g	10.5-12m /34-40ft	100m ² /1070sq ft	1038g/2lb 4oz
012A	2400kg/5280lb	10.5-12m /34-40ft	100m ² /1070sq ft	

The SWL (Safe working load) is a tested load. The B/L (breaking load) is approx. x 80% of the SWL. The sail area and boat length are a guide only.

Monohull and multihull develop different loadings. Please contact Beau Marine for assistance with your selection.

Code Zero Furler Model 010S

Designed for the code zero 'small boat' market up to 10.5 mtrs and as a staysail furler on bigger boats.

- The 010S is milled from solid aluminium and uses a high load sealed stainless steel bearing.
- The 010S is of simple design and constructed to withstand the environment yacht racing can provide.
- The 010S uses 6mm endless line.
- By rotating the drum, the anti-torsion rope will turn causing the sail to furl around the luff.
- The halyard tension must be tight when furling.
- The sail can be lowered and placed in a bag.
- Wash the furler with fresh water when storing.
- Drum size is 95mm.
- Safe working load is 900 kg. (.9 tonne)
- Suggested sail area 40m²*
- Weight 290gm/10.3oz
- * All suggested sail areas are an estimate only.
- Sailing on different wind angles will increase or decrease loadings. Talk to your sail maker or direct to BEAU MARINE.



Code Zero Furler 012M

For sails that include an anti-torsion rope sewn into the luff of the sail.

- Installation is simple. Just attach the furler to the tack and attach the halyard swivel to the head.
- The 012M uses 10 to 12mm endless line.
- When the drum is turned the anti-torsion rope will also turn. It is very important to ensure that the halyard tension is tight. The sail will furl around the anti-torsion rope allowing it to be lowered and stored in a bag when not in use.
- Be sure to wash with fresh water when storing.
- Milled from solid aluminium including the housing for the endless line.
- Bearings are sealed stainless steel.
- The endless line enters and exits through two sets of BEAU fairlead rollers.
- Drum size is 145mm (approx.. 6")
- Weight: 374gm/13oz
- Safe working load is 2400kg (2.4 Tonne)
- Suggested sail area 100m² (1070 ft.)*



Racing Code Zero Furler 012R (Carbon)

The race version of the 012M.

- A weight saving carbon housing replaces the aluminium.
- All other specifications are the same as the 012M.



Top Down Gennaker Furler 012TD

For sails that do not have an anti-torsion rope sewn into the luff .

- The 012TD is a “top down furler”. The tack of the sail is attached to the rotating tack ring on the furler preferably by a binding of 2mm dynema or a similar product. Do not use steel shackle.
- The head of the sail is attached to the halyard swivel.
- The anti-torsion rope connects the head swivel to the furler swivel .
- The 012TD uses 10 to 12mm endless line.
- When turning the drum the head will turn first while the tack remains still. The result is that the gennaker will furl from the top down.
- The system is ideal for cruising and short-handed sailing and is light weight so could also be included in your race kit.
- Milled from solid aluminium apart from the 316 stainless steel shaft.
- The furler is fitted with a sealed stainless bearing and the tack ring has a further two sets of stainless steel sealed bearings.
- Be sure to wash with fresh water when storing.
- Drum size is 145mm (approx. 6”)
- Weight: 374gm/13oz
-
- The endless furling line enters and exits the furler through two sets of BEAU fairlead rollers.
- Custom made thimbles for all models are available from Beau Marine.
- Safe working load of 2400kg (2.4 tonne)
- Suggested sail area 100m² (1070 ft.) *



BEAU MARINE

Beau Marine 012M & 012R

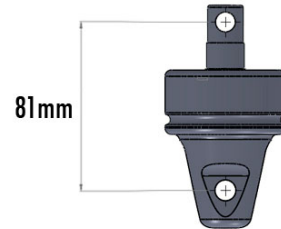
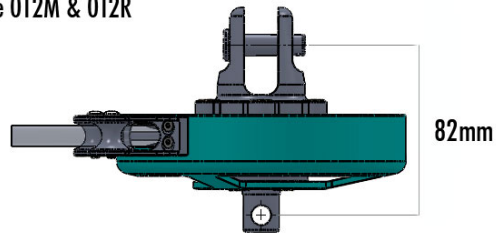

Head Swivel for 012M, 012R and 012TD

Beau Marine 012TD

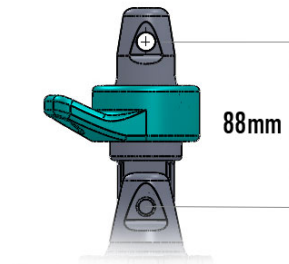
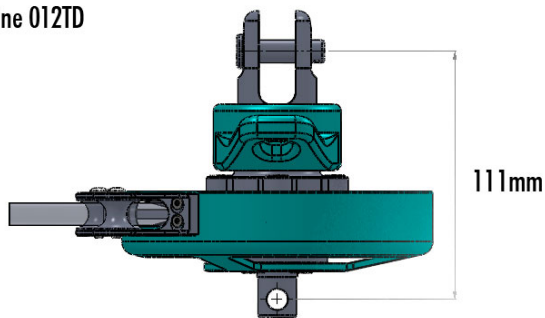

Adapter

Beau Marine 010S

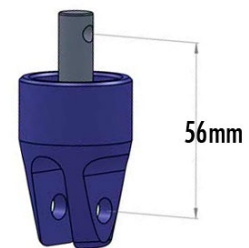
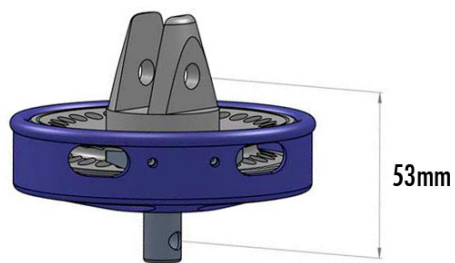

Head Swivel for 010S